

**COLLECTION:** Papers of Frank H.H. Roberts at the National Anthropological Archives

**CDI  
ACCESSION  
NUMBER:**

000149

**ERRATA:**

Copy dark in some places.

**COMMENTS:**

Handwritten.

**CITATION:**

Leonard, Jane  
1940 Bc 53, Field Notes. In Papers of Frank H. H. Roberts, Box 8, National Anthropological Archives, Smithsonian Institution, Washington, D. C.



Frank H.H. Roberts Jr.  
4851

Archaeological Sites

Chaco Canyon, NM  
Bc-53

Box 8

NATIONAL  
ANTHROPOLOGICAL ARCHIVES  
SMITHSONIAN INSTITUTION

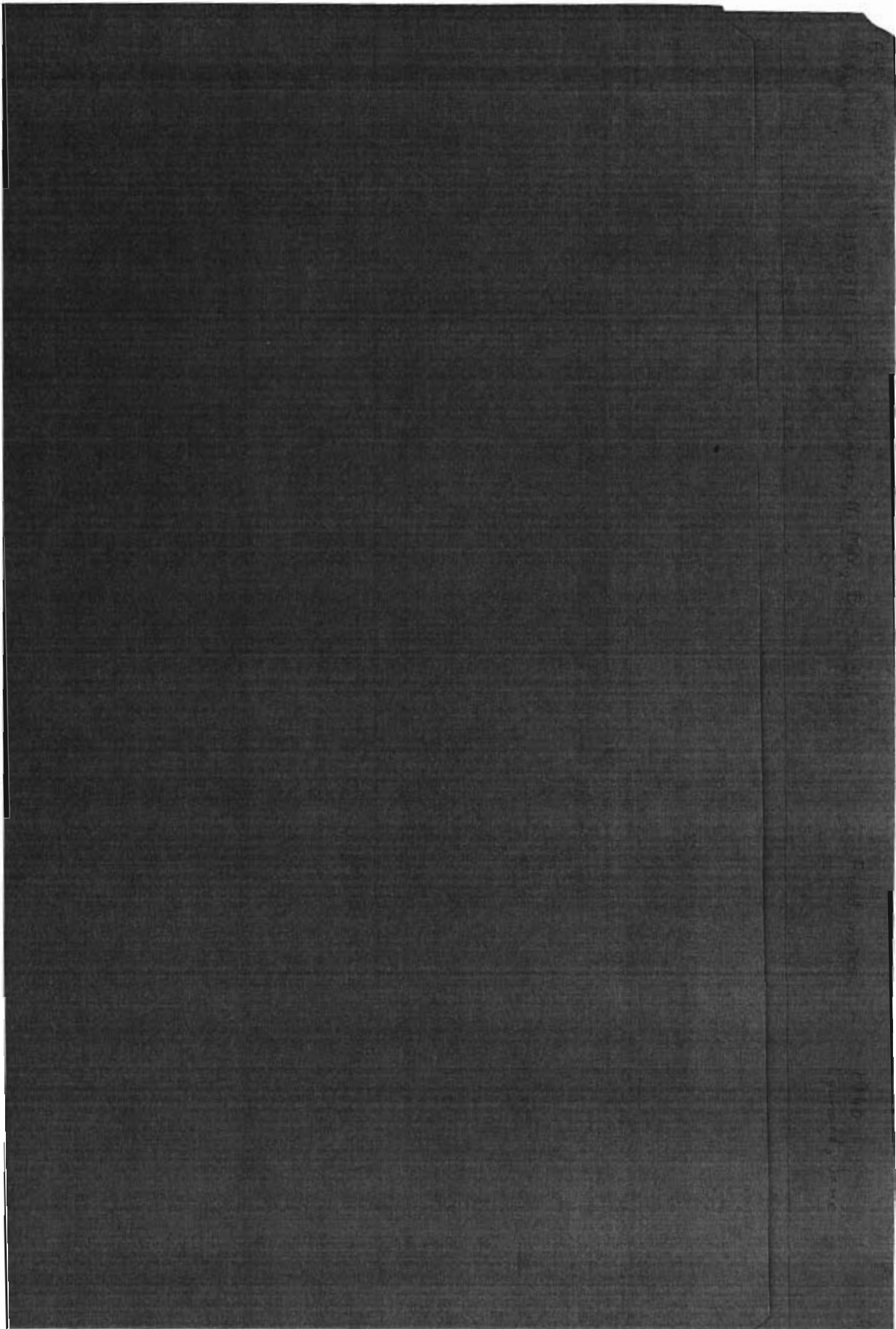

Field Notes on Kiva B.

BC-5 3

Jane Gould

Excavation was started along N. wall, and part way along the E. wall. Approx 21" down. Bench was followed along N. wall. The fill was then taken down in layers to floor.

Level I - 21" down to top of bench  
Level II - 40" down from top of bench.  
Level III - is 11" up from floor level. The floor was located 72" down from B.M. 6.B.10. The N. half of the room was taken down to floor level, then the rest of the fill was taken down about its respective levels to floor level.

The fill consisted of rocks and shale fallen from the roof and walls, all then the fill were scattered charcoal, twigs, rabbit bones, turkey bones and

rodent bones. such as  
Peromyscus mandibles.  
No ~~skull~~ but was male  
of the ~~fill~~.

The walls particularly  
those of the bench, still  
contained much of the  
plaster. The masonry  
was typically Chaco  
masonry.

The structure was  
that of a square room  
which had been made  
over into a Kiva by  
rounding the corners  
by putting a punch across  
the N and S walls.

I Manos was found in  
level I

II Manos were found in

1 Manos was found in level I

11 Manos were found in level II.

3 Manos were found in level III

Two pieces of petrified wood were found on the bench along N. wall.

Charcoalized corn cob 1" long was found in level I above bench along N. wall.

### Worked Stone

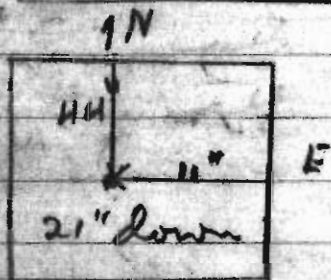

2 1/2" long

2" wide

1/4" thick

It was smoothed and showed signs of having been pushed.

## Crude Stone Maul

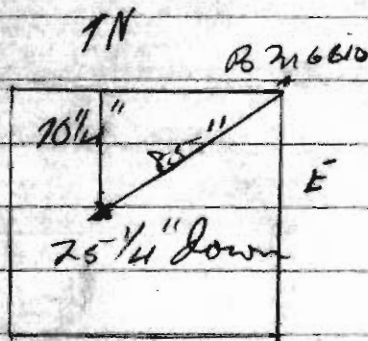

BC - 5-3  $\frac{20}{42}$

22 cm long

11.5 cm wide

5.3 cm thick

Level II

Restorable black corrugated vessel found at various places along N. wall. Approx 22" down. Level II

## Grooved Stone Maul

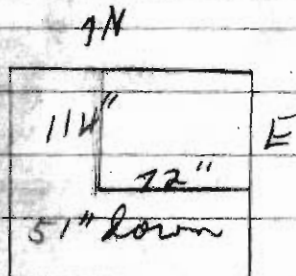

BC - 5-3  $\frac{20}{21}$

20 cm long

9.8 cm wide

2 cm thick

## Bone Awl

1N

BC - 5-3  $\frac{30}{21}$

## Bone Awl

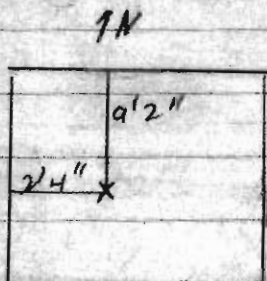

Be 53  $\frac{30}{31}$

10 cm long

2.5 cm wide

level II

## Awl point

Be 53  $\frac{30}{31}$

3.1 cm long

1.9 cm wide

The tip only was found in  
fill in level II.

## Fossil Shell

showing signs of having  
been scratched.

found in level II

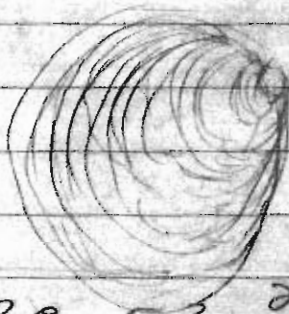

Be 53  $\frac{30}{31}$

fac 7.6 x 6.0

Metate

broken in half (each half not found)  
1 3/4" wide

8" long (broken)

2 1/4" thick

1N

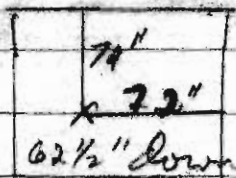

level II

Metate

(next to one above) (broken)

1N

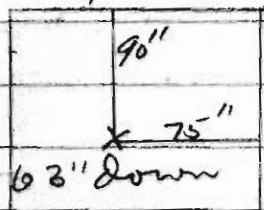

1 2" wide

9" long (broken)

1 1/2" thick

Rodent track found level II

Part of skull (human)  
found in level II.

Piece of skull (human)  
found in level II.

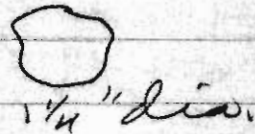

two flakes of obsidian found  
at base of N. wall - level II

Bone of deer foot found  
in level II

Beam set in notch in  
bench along N. wall (bench  
(just beneath the top)

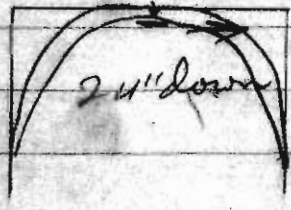

2 1/2" wide  
5" long  
level II

Sealed up notch located  
just 30" underneath beam in  
sid wall of N. bench. It is  
9" wide  
6 1/2" long

Pieces of burned shell  
found along N. wall  
on base of level II

Half bore hole

45" from E. corner  
of ditch in wall  
18" from S. wall  
26" down in  
level II



B C 53  $\frac{30}{45}$   
1.9 long  
.9 wide

Impression of checker  
board twill mat about  
1" above floor level.

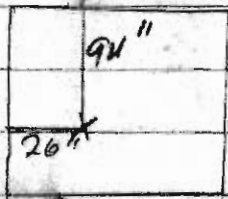

71" down



approx 1' square

level III

Paint Pallet

found above



## Paint Pallet

found above  
floor level III  
has a little  
red paint on it



BC 53  $\frac{20}{40}$   
71 cm long  
5.9 cm wide  
2.5 cm deep.

## Bone Awl

1N

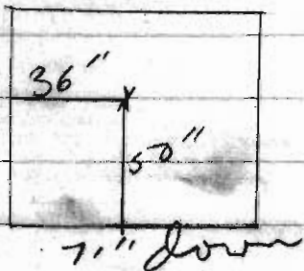

BC 63  $\frac{30}{46}$   
5.5 cm long  
1.3 cm wide

Under series of 11 stone slabs  
in level III were located  
squash seeds, rabbit bones, twigs,  
frown rods, charcoal, and  
shreds. The earth showed  
signs of having been tumbled.  
55" from E. comp. ditch in S. row  
67" from E. wall.  
65" down.

Piece of beaver horn 1"  
long found in fill  
above floor level III

Flag horn

In S. wall  
on E. corner  
of notch on  
floor level III

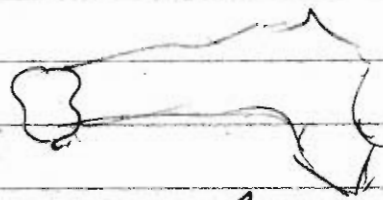

7" long  
1" dia.

1 N

Kiva B.

12' 10"

1 N

River B.

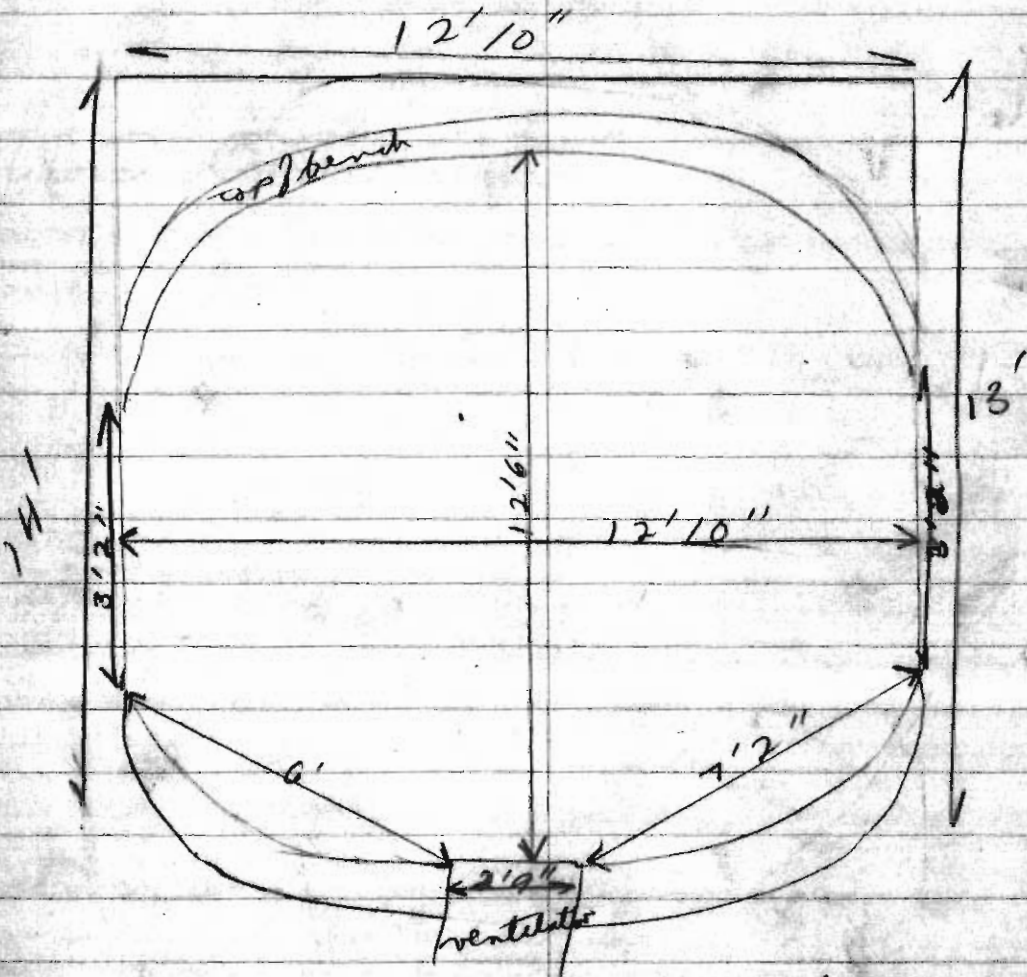

benches: 21" down (floor level 72" down)  
13 1/2" wide (from 2x6 B.)  
51" high

Sorry I'm not a better artist!

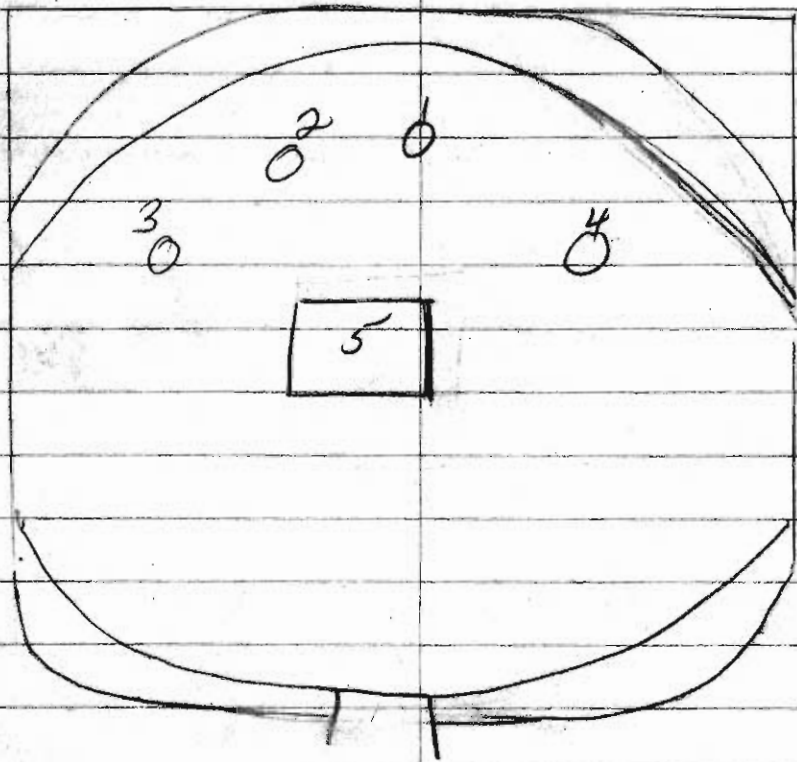

I - Sipapu:

5'3" diameter

2'7" - N wall

5'3" - W wall

II - Sipapu:

3x3" dia.

3'7" W wall

3'7" N wall

III - Sipapu

3x3" dia.

2'9" E wall

III - Sipapu

3 x 3" dia.

2' 4" E. wall

4' 9" N. wall

IV - Sipapu:

8 x 8" dia.

2' 7 1/2" E. wall

3' 10" N wall

V Firepit:

2' 2" square

6' 3" N wall

4' 1 1/2" S wall

pieces of stag horn, skull  
and shovels found in  
the fire pit. At one dug  
approx 5-6" deep.

Levels were not finished  
when the Museum was  
locked up. So I did not  
get to finish my skull  
classification. This may  
be found in the museum

files for Kiva B.

I enjoyed working under  
you very much, Mr. Roberts,  
and hope to swim in  
more of your Kivas some  
day. It has been a real  
pleasure knowing you.

This is not applicable  
because I'm only  
auditing it - so you  
cannot flush me. I'm  
safe in that way at  
least.