

COLLECTION: Chaco Archive

**CDI
ACCESSION
NUMBER:**

000632

ERRATA:

COMMENTS:

(C86074/VA2102B) Student Field Notes on Bc 52 (1940-1941); Sketched Plan.

CITATION:

Mulloy, William
c.1941 Field Notes on Excavation of Bc 52. Chaco Archive No. C86074, NPS Chaco Culture
NHP Museum Archive, University of New Mexico, Albuquerque.



(1)

C-7574
VA 2102B-71
C86074

BC = 52 - From Wm. Mulloy

LOCATION - a talus site, ^{in a niche} on the south side of the canyon - ~~in a niche~~ opposite Pueblo Bonito.

EXCAVATED - 1940 season & first 2 weeks of 1941 season

He thinks there were 2 periods represented or possibly only 1 occupation with considerable remodeling.

The sand and siltstone material was divided into 2 groups, (1) that definitely associated with floor levels and (2) material above floor levels.

The material ^(walls) exposed at the upper levels was recorded and then removed to expose earlier structures. All of the material (walls) was removed down to the bedrock. Only the oldest level of occupation was left.

There was no refuse mound.

SITUATION

The cliff is 45' high. The talus area was approx. 30' long & extended 9' out from the cliff. To the north the talus was lower and 90' wide (?).

MASONRY

He lists 5 different types of masonry, none of which follow any previous descriptions. (There are 8 pp of these). Four of these ⁵ types are variations of uncovered styles in which the rock faces form the wall surface. He lists several walls which show 2 ~~st~~ types on one side and a 3rd type on the reverse.

Blocks were crudely shaped, little pecking or grinding, uncoursed & vaguely coursed. Rock spalls, few sherd spalls.

Walls considered from the stratigraphic view - no differentiation through time could be noted. All types were in use throughout entire occupation. (I) irregular blocks & spalling (II) coursed blocks with little spalling (III) irregular blocks without spalling (IV) irregular, poorly surfaced & used as foundation, outside of kiva below surface etc. (V) Dry, without spalling, blocks 4' long, for terraces & foundations.

EARLIEST PART

He calls the lowest levels the Kiva II complex in the talus area of 30' x 9'. Kiva II excavated into shale. (It is apparent that this is much more than 9 feet)

(3) Mulloy - 52

VAD108B-93

Kiva II ^{11 ft in diam below bench.} west side 7' high, east (outside, away from cliff) 1' high. Wall varied from 1.5' to 0.7' thick, bench 2.7' high 0.7' thick.

Do use circulator & not keyhole? bench recess?

ventilator subfloor, 5.9' long 1.4' deep, went out east side. Slats covered by poles small poles.

Finj. D - rectangular, slab lined.

Floor, adobe

Plaster: 4 coats

D SHAPED ENCLOSURE

~~Room~~ Kiva II & adjoining rooms or areas enclosed in D shaped structure, 22' long, 1' to 5' high. a lot of walls described which are apparently retaining walls.

Room 16 - 3.1' x 11.4' about 6' above the kiva floor.

Floor plastered, no fireplace or other features. no door remains in low wall but 1 raised stone step.

Room 7 - 8.5' long. two floor levels, lower adobe, upper partly plastered. Floors separated by 0.4' sand & refuse. no fireplace, features or doors. Roof entrance?

(4) mullay - 52

VA2102B-94

~~Bins 17-18.~~

Rooms 17 & 18 - Bins ? 3.9' x 2.5' & 2.5' x 7.1'

The kiva II complex was a D shaped enclosure containing 1 kiva, 2 rooms and 2 storage areas or bins, plus numerous retaining walls.

THE NORTHERN ROOMS

North of kiva II and lower.

Room 3 - a wall about 4' high enclosing an area 12' E & W x 5' N & S. ~~has~~ a floor and no room features & no door. Wall plaster.

Kiva III early? 24.5' N. of kiva II

diam. 11.5' above bench. Bench 0.8' high wide, 2.9' high. Diam 10.7' below bench. a little plaster. (no bench recess?) Ventilator 20 degrees S. of east 3.5 long inside kiva. a trench, roofed with small poles - 0.2' diam, just below floor level. ~~NO fireplace~~ NO fireplace in kiva

(5) mullay - 52

VA21028-95

Rooms 45-46 (partly on refuse)

north of kiva II a long wall 22' long
parallels the cliff. it was 1.8' high.
walls at right angles made rooms 45-46.

45 adobe floor, 2 coats wall plaster, basin
shaped, adobe lined fireplace. no door opening

46 no features, no fireplace & no door.

LATER OCCUPATION

He means more building, not 2 separate
occupations. He suggests a fairly general
reorganization over a short period of time.

Above Kiva II

Kiva II filled up (7.3') with refuse, sand
building mths. Then the top of the kiva wall &
all other walls in D shaped enclosure were
leveled off to a height of 1'. The outside wall

(c) mullay - 52 -

VA2103B-710

then rebuilt, slightly offset.
The area within the D then filled in.

(Kiva I) built on east side of original D.
circular, 11.2' diam. The east 1/2 of the room
washed away. on west side, wall 1.6' high.
(was it a kiva?) only feature a rectangular
slab-lined fire pit. no bench, no vent shaft.

Rooms 2 & 4 - floors & wall plaster, no features
& no doors.

Room 15 - a room with a bench (?)

Room 19 : adobe floor & walls plastered, a second
floor 0.3 above this. Rectangular slab lined fire pit
in S.E. corner.

viga sockets jerked in the cliff indicate a second
and third row of rooms against the cliff. rooms 6' high?

(7) mulloy-52-

VA2102B-97

Rooms south of Kiva II

a parapet or retaining wall 14.8' long, dry masonry. Here were rooms 19(?) 9, 8.

Room 8 mostly under overhanging cliff. door in east wall, was 1.3' wide, sill was 0.7' above floor.

Room 9 door 1.5 wide and at floor level, also most of room under overhanging cliff.

Rooms North of Kiva II

Kiva III filled up and withers wall built across A & D support rooms against the cliff.

Room 37- ~~Three~~ Three floor levels - a large area divided into rooms 11 and 13 (?) no features & no doors

Room 12- floor & wall plaster, no other features

Rooms 45 & 46 top down to height of 1.8' feet, filled up & rooms 27 & 30 built over them There later walls built right on top of razed walls, (How does he know this?)

(8) Mulloy - 52

Room 27 - no features

Room 30 - door in east wall, door 2.1' wide,
sill 0.9' above floor.

Room 23, under cliff - basin fire pit, T shaped
door in east wall

Room 24, under cliff, no features

Room 21, a little room under ledge, a rectangular
also lined fire pit.

Room 22, a little room under cliff.

Room 26 19' long, 9.6' wide, almost completely
destroyed

Room 20, also eroded away

Room 25, " " "

NON-CONTIGUOUS STRUCTURES.

KIVA IV, dug into talus in front of 27 & 44, 21' out
from cliff and lower than rooms. Diam. above
berch was 13.2'. Berch 2.7' high, 1.0' thick. (Note -
all of his descriptions say the outer wall was lined
first and the berch second - 2 compact walls, each
faced. This seems unlikely.) He says of this kiva,

(9) Mulloy - 52

UA21028-77

"after the kiva had been used some time the banquette was discontinued upward with identical masonry"

Four layers of floor. Ventilator shaft, sub-floor, 30 degrees south of east, 4.9' long inside. Rectangular, slab-lined fire pit.

Fill in kiva all wind & water deposition, no refuse.

Room 53 a bin between 2 large rocks

Room 54 - another crack between 2 rocks.

Room 40 - against side of cliff, behind a rock, only 2 walls remain.

chipped stone

only 4, 3 projectile points & 1 problematical.

1. point or knife, brown flint, shallow side notches, flat base 3.1 inches long, 1.0 inch thick
2. point of brown quartzite, same shape, 1.2" long, .55" wide
3. corner notch, convex base, poor flaking, 0.6" long
4. long narrow flake with slight retouching

(10) mulloy - 52

VA2102B-100

Pecked & Ground Stone

- 9 pottery ~~pecked~~ peckers.
- 3 flat polishing or grinding stones. 1.8" to 2.5" diameter
- 1 red shale pendant
- 1 cylindrical turquoise bead (?) cylindrical bead (?) or disk (?)
- 2 frags of metates (what shape?)
- 3 frags of manos (what shape?)
- 2 pecking stones of quartzite

Bone & Shell

- 13 awls, 4 of deer metapodia, joint ground down 1 bird bone, 2 rodent bones, 1 from deer scapula 1 deer femur, 4 of splinters of long bones
- 2 game counters
- 1 figure & bead
- 1 olivella bead
- 1 frag glycymeris bracelet

(11) mulloy - 52

Vegetal

- 1, mat, stalks of ?, was 1.9' wide, held together by a pair, then twined (?) fibers.
- 3 frags. of twined sandal(?) fiber?
22 threads \varnothing inch.
- 2 frags. of twined over 2, under 2, material?
- 1, frag digging stick, ovoid in cross section
- 2, frag of digging stick handle.

Petroglyphs

Nothing extracted from this.

Illustrations

apparently 6 pages of photos, all but 2 torn off. (1) is ?, the other is photo of drawing of masonry types.

Pottery

was done by Lange & Cline. (Florence Suter)

(12) Mully - 52

VA2100B-102

conclusions Etc

There are no ~~of~~ conclusions, discussion or summary. Nothing.

(Remarks, & V. Mully's paper uses up 71 double spaced pages. It is all involved descriptions of walls and very exasperating reading. It contains many marginal comments by Rector & these in turn have been commented upon by W. L. Bliss.)

Note book -

2102
VA2102B-103

by ? - BC-53 - 1941 digging -

Burial #(?) - noted. 3 bowls near head - Nos - B/w -
(500201), plain bowl(?) 500373(?), corrugated
(500202)

Burial #6 - noted, frag. B/w bowl (500334)

[ON SEPARATE PAGE PLEASE]

BC-55 - Talus site (by ? - 1941) Notebook -
noted many Tusayan Poly sherds

burial "beneath cliff - 1 mandible, 1 femur, 1 bowl"

Notebook Emily Ross

VA 2102B-11

BC-53 - work in 1941 - digging some rooms
and deeper

#1
Burial below floor, room #7-

poor condition - ~~undisturbed~~ back partly flaked
was turquoise ear bob-

Assoc. pottery; Burial 1

- (1) small pitcher 2 1/2" high, 2" body diam. (inside #2)
- (2) black on red jar (Puerco B/on red.)
- (3) black on red bowl (Puerco B/on red)
- (4) black on white bowl (escavada-)

Burial #2 Room 7- BC 53

~~open~~ ^{open} red (?) mat, flaked on side, also tumbled mat,
2 ps turquoise, frags. celad oaked, pure worked
pure 14" long

1 pitcher unidentified

Burial #3 - says Chandler took it out.

Notebook

BC-53 - 1941 Theodora Buggeln

Room 8 - infant skull, under matate (below previous
burial #11) "path made around body - body flexed"

Room 10 - 2 adult skulls & 1 child skull, "1 small
vase nearly complete"

(1)

VA 21028-
106

BC-58 - Architecture

from - "Architectural features of BC-58-59 & 50"
by Barbara R Cornett - 1947 -

SIZE 14 rooms & 1 Kiva plus 2 sub-surface
kivas under room 11. Substructures were
noted but not fully examined

Masonry - varies from wall to wall, appearance of
having been constructed from time to time as
additional rooms needed. Smooth blocks
separated by rows of spalls, uneven banding
Newby type 7 - (1100-1116 AD)

OPENINGS many rooms had no openings; rooms 1, 2, 6,
7, 8, 9, 10, 11. Possibility of roof entrance.

3/13 = 26" above floor, was 16" wide, stone ~~lintel~~ ^{1,14" x 6" x 13"}

3/4 = stone ~~lintel~~ ^{1,14" x 6"} - was blocked

5/12 = blocked with like masonry, stone ~~lintel~~ ^{1,14" x 6"}

5/3 = blocked with unlike masonry - similar to consid.
in BC-59. stone ~~lintel~~ ^{1,14" x 6"}

14/11 = blocked, unlike masonry - 14" wide - stone lintel

14/11 = blocked also - 14" wide

(2) Cornett - BC-58

VA 8102B-107

Stone lintels indicate scarcity of wood?

Floors: hard, packed adobe, after several occupation levels 2" & 3" apart.

Roofing: need impressions in adobe were $\frac{1}{8}$ " to $\frac{1}{4}$ " in diam. Impressions of poles 2" in diam. No vega sockets in walls.

Firepits: Hearths in rooms 1, 3, 7, 9, 10, 11, 13

1 - basin shaped 11" in diam in center floor room 1.

1 - basin shape in room 13

in corners of rooms 2, 7, 9, 10 (?) (these seem to be indications of fire rather than fire pits & v)

in room 11, several occupations, from top down

(a) basin shaped, ^{at 20"} (b) basin shaped at 23" (c) stone lined 15" x 11" and appears to be built on top of the

pedestal of an abandoned kiva. Note this is the only rectangular, slab lined firepit in either BC-58 or BC

59.

(3) Cornett - Bc-5B

VA 2102B-108

Cists & bins

Room 6 - 1 bin 28" x 18", slab walls 7" high
slab lined floor (is this a mealing bin?) yes -

Kivas

A east of main house group. masonry Hawley type B.
bench 7" wide, 3'5" high, bench recess 44" wide on
east side. pilasters - 2 (?) at NE & SE. are
high 30" wide 5" high. shaft sub floor - 44"
long inside room, low stone slab deflector.
no upper. bottom of shaft is floor of small
joist joist tied together (?) niches 2, in bench,
one each at N & W sides.

B & C - both in room 11

~~A~~

B just a frag. of circular wall.

C keyhole to south, 2 pilasters & possibly 4 (?)
(separ. incomplete when this written)

(4) correct - Bc-58

VA2102B-109

CONCLUSIONS

Bc-50 is earliest of the 3. Bc-58 later, & Bc 59
last. Bc 50 abandoned ~~at~~ when 58 occupied - Both
58 & 59 in part contemporaneous and 59 outlived
58.

(Remarks - well written & clear paper - has
plans of site at back which should be saved to
identify rooms & kevas.)

Bc- 59 - Architecture

From ~~Barbara~~ Barbara Cornett, 1947 - Architectural Features - Bc 58 and 59.

Size - 12 rooms, 4 kiosks & 4 unnumbered areas, rooms or plazas at west. (Note - only $\frac{1}{3}$ to $\frac{1}{2}$ excavated).

Masonry defies description, poor, large rock, Hawley's type 10 - (1116 + ?) all rough and unfinished. Big vertical slabs $12" \times 16" \times 8"$ in wall face. Some very large slabs vertical in wall face - $33" \times 12"$ wide & $36"$ high $\times 12"$ wide "other stones of similar size are used horizontally to top off some of the walls." (at ceiling height? Not walls of ceiling height?)

Walls of room 6 burned & blackened, human bones on floor.

openings: majority of doors sealed. No doors in rooms 4, 7, 8, 12.

$\frac{1}{2}$ = sealed, masonry similar to wall - is $17"$ wide stone lintel.

$\frac{3}{5}$ = sealed, stone lintel

(2) Cornett- BC-59

5/6 = sealed, 14" wide, stone lintel, sealed with similar masonry.

9/kiva 2 = sealed, kiva 11 joint dates room 9.

10/11 = sealed with similar masonry.

Floors: difficult to locate. Room 8 has 4 levels at 7", 13, 31, and 54" depths from wall top.

"Where sub-structures appear, floor levels appear just above the submerged walls, showing that the upper stories were built on the filled-in rooms."

Roofs: impressions of reeds or branches $\frac{1}{8}$ to $\frac{1}{4}$ diam in roof adobe. Fragments of poles 2" in diam.

Firepits very few. "It is likely that some were located in the floors which went undetected during excavating and were dug through."

Five blackened ~~with~~ east wall of room 6. Possible hearth in room 7. Room 12, hearth against east wall. It was 16" wide and 8" deep. "None of these hearths were lined, being merely a depression in the floor level."

(3) correct - Bc-59.

cists & bins:

one mealing bin. 3 contiguous bins of upright slabs, 12" high, slab bottom. (No metal in place?)

one circular wall niche. 5" deep, empty & closed with a stone duck.

Kuvaa - 4 - (1 unexcav., 3 keyhole to south.)

I - in square room - unexcavated.

II - in square, fine black and plaster. in keyhole bench is 9" wide, 28" high, no pilasters. keyhole to south is 70" wide, above floor opening is 10" wide. no deflector or fireplace. (doubt if excavated?)

III keyhole - (only partly excavated)

IV keyhole - better masonry. bench - 9" wide 33" high, keyhole 6' wide - above floor opening in keyhole. one upright deflector slab. fireplace not excavated.

[No 2 = Two Rooms]

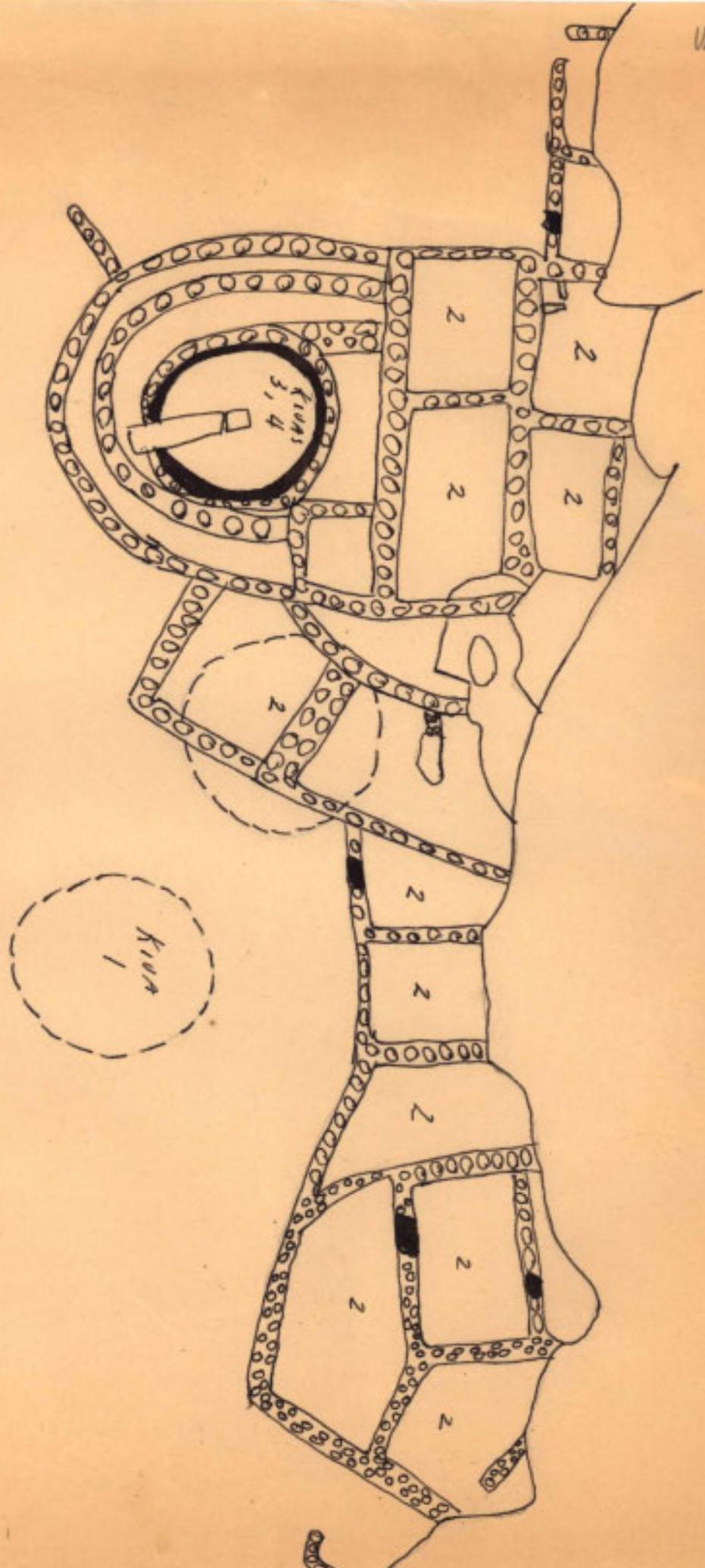

Bc 52